

Accepted as Shown
 Revise and Resubmit
 Accepted as Modified
 Date: _____
 Per: _____

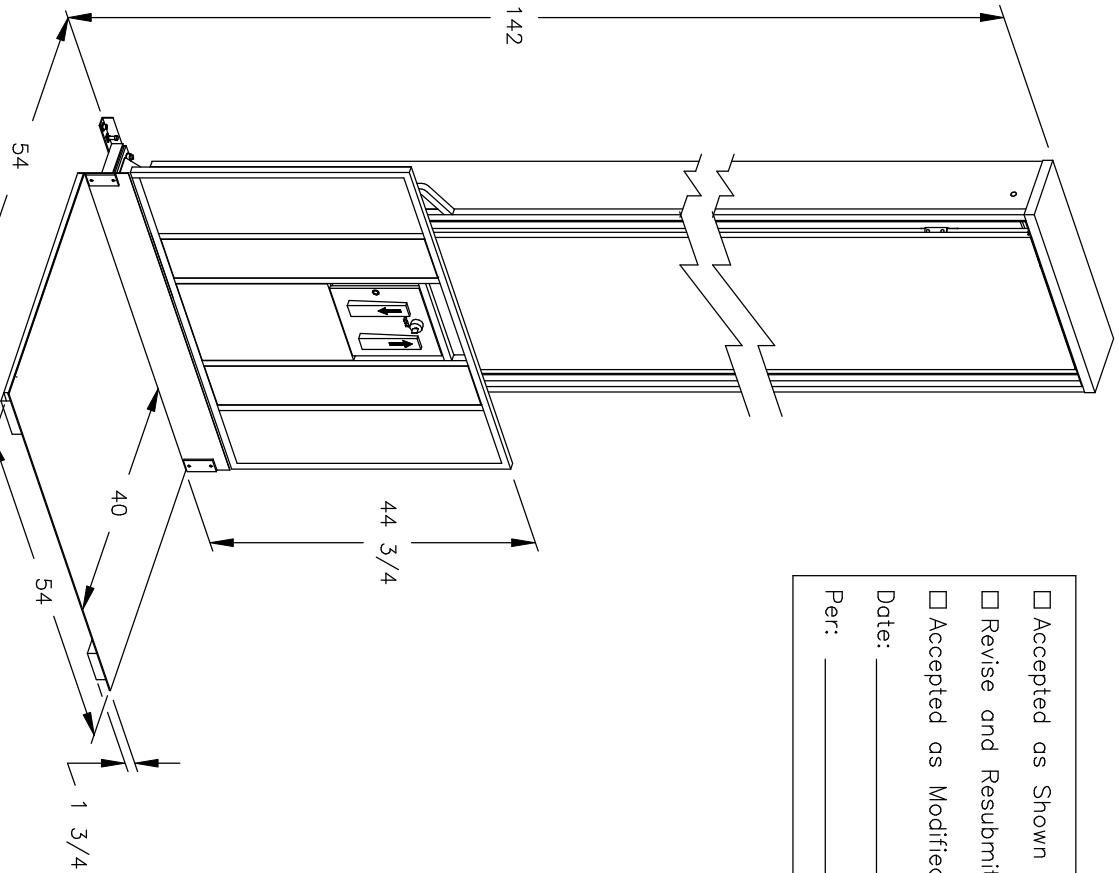

TRUS-T-LIFT DIMENSIONS

TOTAL TRAVEL	120	INCHES	No. OF LANDINGS	2
--------------	-----	--------	-----------------	---

LOCATION ENCLOSED RESIDENTIAL TRUS<T>LIFT
 3 STOP ADJACENT ACCESS SAMPLE DRAWING

ARCHITECT

GENERAL CONTRACTOR

- SPECIFICATIONS:**
- 40" x 54" LIFT PLATFORM
 - 54" x 54" FOOTPRINT
 - 142" TOWER HEIGHT
 - 0" - 120" LIFT RANGE
 - MAXIMUM LOAD 550 lbs.
 - 8 FEET/MINUTE LIFT SPEED
 - SCREW NUT WORM GEAR DRIVE
 - MOTOR: 1/2 H.P. 110V A.C.
 - POWER SUPPLY: 110V/1PH/60HZ C/W 15A FUSED DISCON.
 - NON-LOAD BEARING BACKUP SAFETY NUT ON LIFT SHAFT
 - SAFETY HANDRAIL ON CARRIAGE
 - ZERO-LOAD START IN BOTTOM POSITION
 - SOLID PLATFORM

PLAN VIEW SECTION

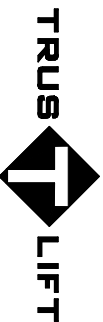
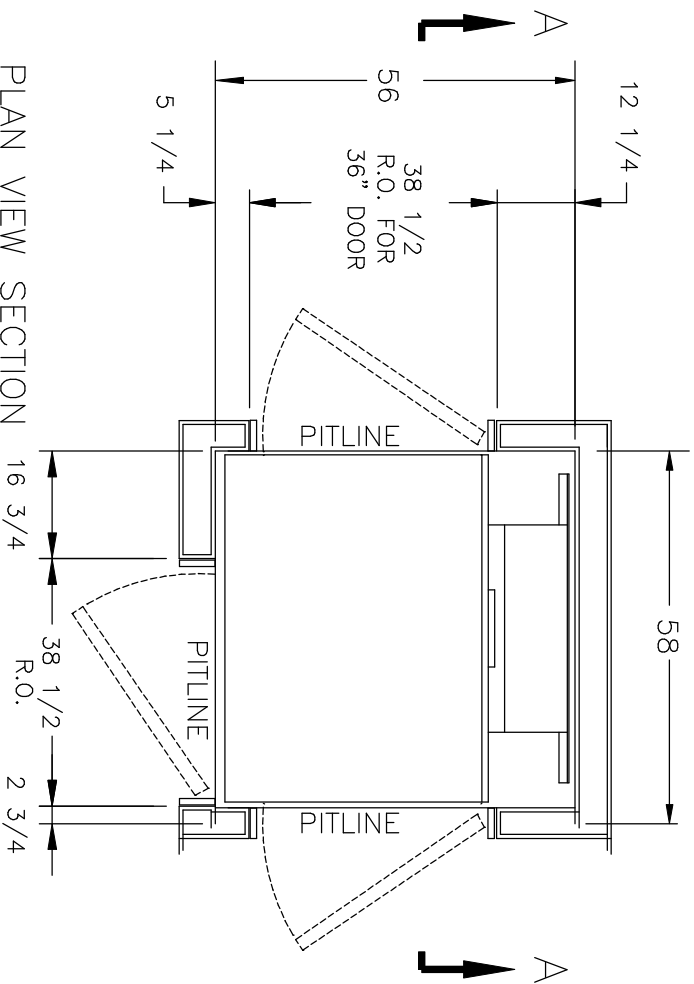

TRUS-T-LIFT ELEVATOR
INSTALLATION DETAILS

DWN. BY: B.H.

CHECKED BY:

SCALE: N.T.S.

DATE: 14/01/05

DRAWING No. 120URLEDDNP-3STOP2 1/2

REV

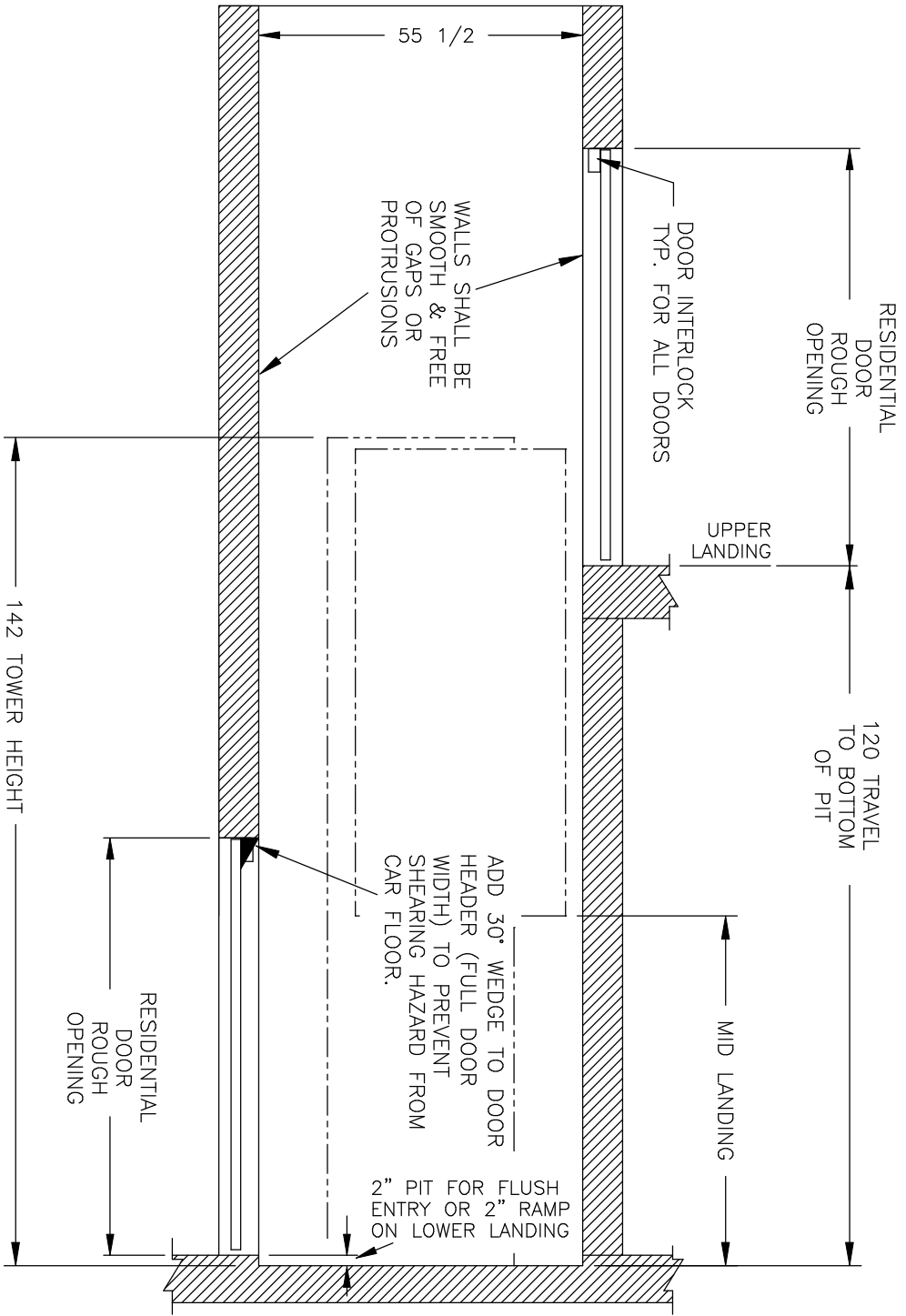

NOTES:
 - Dimensions are in inches
 - Designed and built to meet ASME-A17.1 Safety Code

SECTION A-A

TOTAL TRAVEL	120	INCHES	No. OF LANDINGS	2
LOCATION	ENCLOSED RESIDENTIAL TRUS-T>LIFT 3 STOP ADJACENT ACCESS SAMPLE DRAWING			
ARCHITECT				
GENERAL CONTRACTOR				

DWN. BY:	B.H.
CHECKED BY:	
SCALE:	N.T.S.

DATE:	14/01/05
DRAWING No.	120URLDNP-3ST0P2
REV	2/2

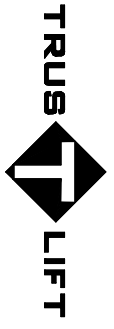

TRUS-T-LIFT ELEVATOR
 INSTALLATION DETAILS